

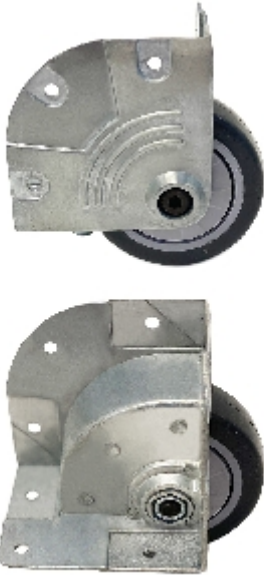





Fixed:

118a 820 799

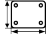
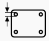

Technische data

Diameter		75 mm
Loopvlakbreedte		25 mm
Bouwhoogte		104,4 mm
Topplaat afmetingen		81,4 x 65,3 mm
Top plate diameter		5,2 mm
Afstand tussen de boutgaten		34 x 50 + 40,71 x 40,71 mm
Draagvermogen		50 kg
Gewicht		430 g